

GNA5 - Triac output

- Intended for resistive loads
- Current ratings 10, 25 and 40 A
- Control status LED
- Output voltage 24 to 280 V AC
- "Zero voltage" switching
- Optimum thermal response
- Control input 3-32 V DC, 18 to 36 V AC, 90 to 280 V AC
- Connection via screws or faston connectors



Specifications

Output	Current (A)	Output voltage	Input voltage	Indicator	Zero voltage	
					With cover	Without cover
Screw	10	24-280 V AC	3-32 V DC	No LED	84 137 900	84 134 900
Screw	10	24-280 V AC	18-36 V AC/DC	No LED	84 137 902	84 134 902
Screw	10	24-280 V AC	90-280 V AC	No LED	84 137 901	84 134 901
Screw	25	24-280 V AC	3-32 V DC	No LED	84 137 910	84 134 910
Screw	25	24-280 V AC	18-36 V AC/DC	No LED	84 137 912	84 134 912
Screw	25	24-280 V AC	90-280 V AC	No LED	84 137 911	84 134 911
Screw	40	24-380 V AC	3-32 V DC	Green LED	84 137 950	84 134 950
Screw	40	24-380 V AC	18-36 V AC/DC	Green LED	84 137 952	84 134 952
Screw	40	24-380 V AC	90-280 V AC	Green LED	84 137 951	84 134 951
Faston	10	24-280 V AC	3-32 V DC	No LED		84 134 907
Faston	10	24-280 V AC	90-280 V AC/DC	No LED		84 134 909
Faston	25	24-280 V AC	3-32 V DC	No LED		84 134 917
Faston	25	24-280 V AC	90-280 V AC/DC	No LED		84 134 919

Output specifications

	24-280	24-280	24-380
Voltage range V (rms) max	24-280	24-280	24-380
Non-rep. peak voltage (Vp)	600	600	600
Maximum off-state leakage at Vmax and T = 25 °C (mAeff per phase)	0.15	0.15	0.15
Maximum current (A)	10	25	40
Minimum current (mA)	100	100	100
Max. non-rep. 1-cycle surge (T=25 °C) (A)	100	250	400
Max. non-rep. 1 s surge (T=25 °C) (A)	30	75	130
I ² t (50-60 Hz) (A ² s)	50 - 41	288 - 240	880-600
Voltage drop at Imax (T=25°C) (V)	1.65	1.65	1.20
Static dv/dt (V/μs)	200	200	200
Thermal resistance junction to casing (°C/W)	3	2	1.4

Input specifications

	3-32 VDC	18-36 VAC/DC	90-280 VAC
Range	3-32 VDC	18-36 VAC/DC	90-280 VAC
Turn-off voltage (V)	1	2	10
Max. controlled current (mA)	14	8	8.5
Response time (close) (ms)	8.33 (60Hz) 10 (50 Hz)	20	20
Response time on closing (ms)	8.33 (60Hz) 10 (50 Hz)	30	30

General characteristics

Operating temperature (°C)	-20 → +80
Storage temperature (°C)	-40 → +100
Input to output insulation voltage V (rms)	4000
Dielectric strength V (rms)	2500
Input/output capacitance (pF)	8
Frequency (Hz)	47 → 63
Material housing	Polycarbonate UL 94 V
Material baseplate	zamak
Weight (g)	97
Safety standards	
Conformity to standards	CE compliant with LVD 73/23/EEC UL/cUL recognized per UL 508
Immunity to electrostatic discharges acc. IEC/EN 61000-4-2	level 2
Immunity to electrostatic fields acc. ENV 50140/204 (IEC 1000-4-3)	level 2
Immunity to rapid transient bursts acc. to IEC 1000-4-4	level 2
Immunity to shock waves according to IEC/EN 61000-4-5	level 2
Immunity to radio frequency in common mode acc. to ENV (CEI 1000-4-6)	level 2
Conducted and radiated noise for industrial environment per CISPR 11	class A

Dimensions

With cover

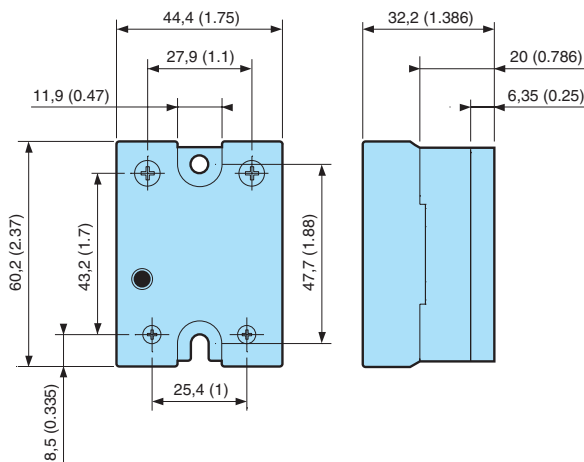

Without cover

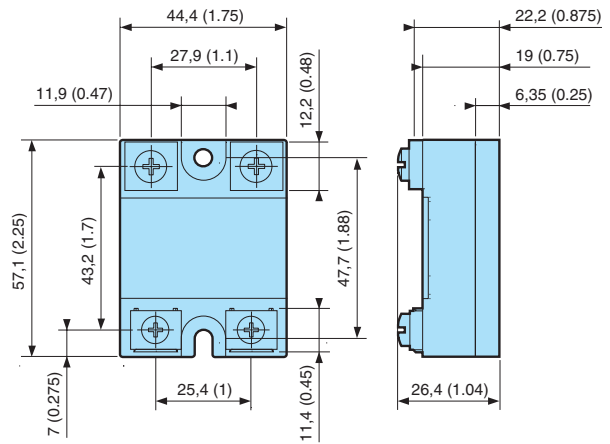

Curves

10 A : thermal dissipation curves

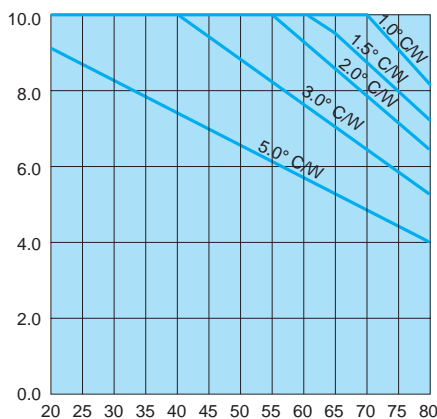

25 A : thermal dissipation curves

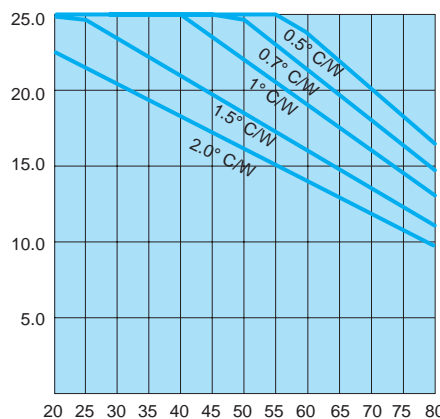

40 A : thermal dissipation curves

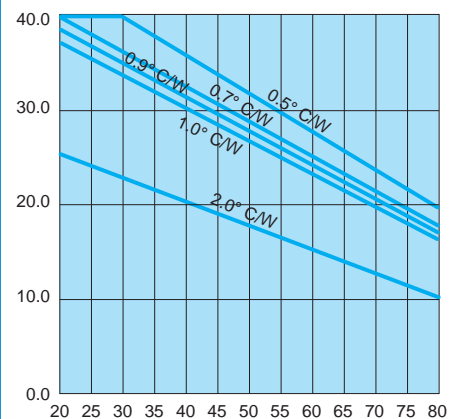

User information

Solid State relays are power switching devices that are subject to internal heating, therefore they must be used in conjunction with a heat sink.