

# GN LC low input current relay

- Ideal for resistive loads application
- Load voltage range from 25 to 100 A
- 1K $\Omega$  input impedance
- IP 00 and IP 20 touch safe protection
- DC control non-regulated
- Zero crossing turn on



## Specifications

Current (A)	Output voltage	Input voltage	Without cover	With cover
25	24-280 V AC	4-32 V DC	84 134 410	84 137 410
25	48-660 V AC	4-32 V DC	84 134 510	84 137 510
50	24-280 V AC	4-32 V DC	84 134 420	84 137 420
50	48-660 V AC	4-32 V DC	84 134 520	84 137 520
75	24-280 V AC	4-32 V DC	84 134 430	84 137 430
75	48-660 V AC	4-32 V DC	84 134 530	84 137 530
100	24-280 V AC	4-32 V DC	84 134 440	84 137 440
100	48-660 V AC	4-32 V DC	84 134 540	84 137 540

## Output specifications

Voltage range V (rms) max	24 - 280	48 - 660		
Non-rep. peak voltage (Vp)	600	1200		
Max. current (A)	25	50	75	100
Minimum current mA (rms)	100	100	100	100
I <sup>2</sup> t (50-60 Hz) (A <sup>2</sup> s)	1250-1041	3042-2535	5000-4166	7000-6000
Voltage drop at I <sub>max</sub> (T=25°C) (V)	1.40	1.35	1.30	1.30
Static dv/dt (V/ $\mu$ s)	500	500	500	500
Thermal resistance junction to casing (°C/W)	0.4	0.25	0.155	0.155

## Input specifications

Minimum turn on voltage (V)	4
Turn-off voltage (V)	1
Maximum input voltage (V)	32
Min turn-on current (mA)	2
Nominal input resistance (k $\Omega$ )	1
Response time (close) (ms)	8.33 (60Hz) - 10 ms (50Hz)

## General characteristics

Operating temperature (°C)	-20 → +80
Storage temperature (°C)	-40 → +100
Input to output insulation voltage V (rms)	4000
Supply frequency range (Hz)	47 → 63
Input/output capacitance (pF)	8
Material housing	polycarbonate UL-94V0
Material baseplate	zamak 7
Protection index	without cover : IP 00 with cover : IP 20
Weight (g)	without cover : 97 with cover : 114
Safety standards	
Conformity to standards	CE compliant with LVD 73/23/EEC UL/cUL recognized per UL 508 CSA recognized per C22.2.no.14-M91 TUV certificated per EN 60950
Immunity to electrostatic discharges acc. IEC/EN 61000-4-2	level 3
Immunity to electrostatic fields acc. ENV 50140/204 (IEC 1000-4-3)	level 3
Immunity to rapid transient bursts acc. to IEC 1000-4-4	level 3
Immunity to shock waves according to IEC/EN 61000-4-5	level 3
Immunity to radio frequency in common mode acc. to ENV (CEI 1000-4-6)	level 3
Conducted and radiated noise for industrial environment per CISPR 11	class A

## User information

Solid State relays are power switching devices that are subject to internal heating, therefore they must be used in conjunction with a heat sink.

## Dimensions

### With cover

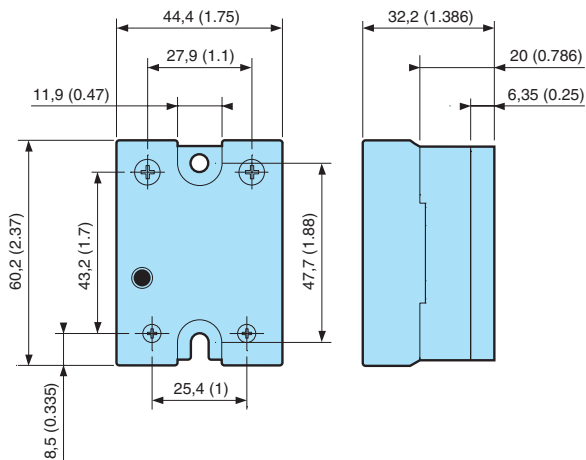

### Without cover

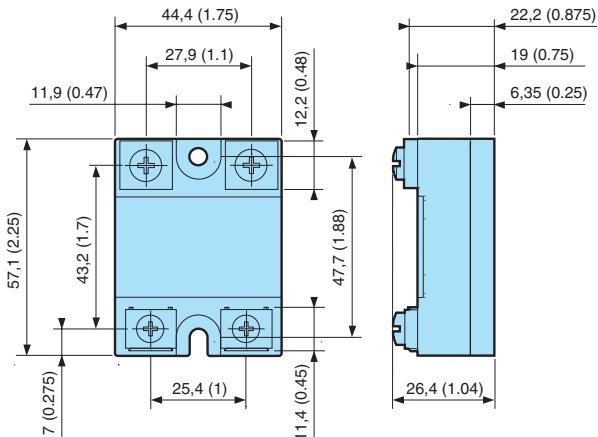

## Curves

### 25 A

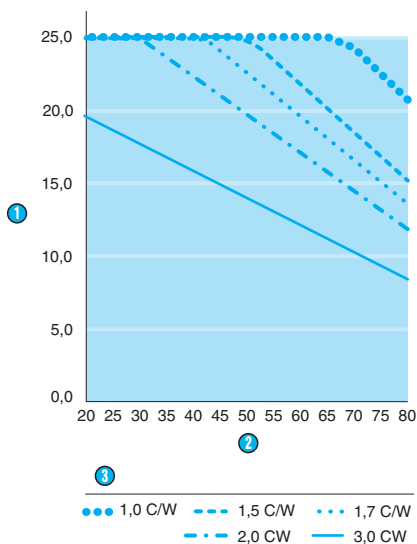

- ① Load current (A)
- ② Ambient temperature
- ③ Heatsink

### 50 A

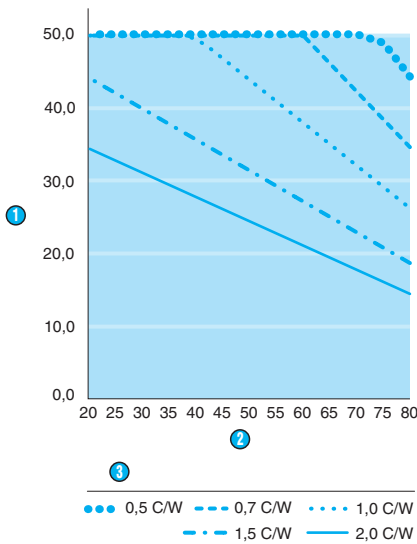

- ① Load current (A)
- ② Ambient temperature
- ③ Heatsink

### 75 A

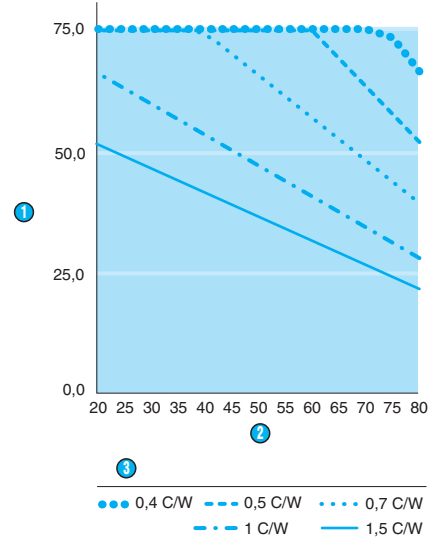

- ① Load current (A)
- ② Ambient temperature
- ③ Heatsink

### 100 A

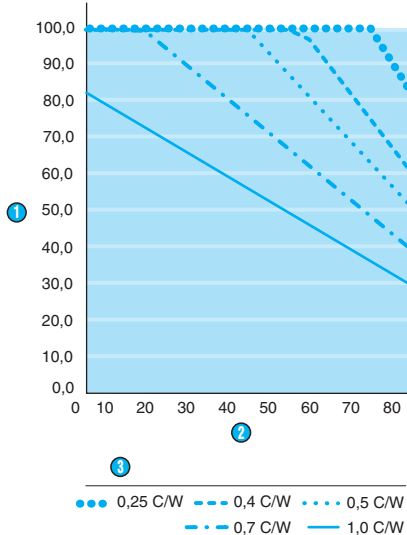

- ① Load current (A)
- ② Ambient temperature
- ③ Heatsink