

# LKM-927G/9278G

17" LCD Monitor/Keyboard/Mouse/Speaker/  
KVMA switch 5-in-1 1U Height Drawer

No special cables required to connect up to 8 computers!



LKM-9278GW

LKM-9278GB

## 5-in-1 1U height Drawer! LCD monitor, keyboard, mouse, speaker and KVMA switch

The LKM-927G and LKM-9278G LCD KVMA control units allow secure access to one or multiple computers from a single KVMA (Keyboard, video, mouse and audio) console in a system rack.

A single LKM-927G or LKM-9278G can control up to 8 computers. The LKM-927G and LKM-9278G both feature 17" LCD monitor and keyboard with built-in touchpad in a 1U rack. The five-in-one space-saving design has either one (LKM-927G) or eight (LKM-9278G) ports to be conveniently installed in 1U system rack.

## Specifications

		LKM-927G	LKM-9278G
System Connections		1	8
LCD Specifications	LCD Size	17"	
	Resolution	1280x1024	
	Luminance (cd/m <sup>2</sup> )	300	
	Display Color	16.7M	
	Viewing Angle (CR=10)	160°/160°	
	Contrast Ratio	800:1	
LCD MTBF		50000 hrs	
Connectors	Keyboard	1 x PS/2 (Purple)	8 x PS/2 (Purple)
	KVMA Video	1 x HDB-15 Male (Blue)	8 x HDB-15 Male (Blue)
	Mouse	1 x PS/2 (Green)	8 x PS/2 (Green)
	Speaker	1 x ø 3.5 Stereo Plug (Red)	8 x ø 3.5 Stereo Plug (Red)
	Power	1 x IEC-320-C14 Input Inlet	
LCM Adjustment		No	Yes
Computer Port Selection		No	Auto-scan/Pushbutton
Switch	LCD Power	1 x Pushbutton	
	Speaker	1 x Pushbutton	
	LCM Adjustment	No	3 x Pushbutton
Power Consumption		42 W	
Color		Black (PANTONE Black C) or White (PANTONE 413C)	
Environment	Operating Temp.	0~40°C	
	Humidity	5%~85%RH	
	Shock	10G acceleration peak to peak (11ms)	
Vibration		5-17Hz, 0.1" double amplitude displacement. 17-640Hz, 1.5G acceleration peak to peak.	
Physical Properties	Housing	Metal	
	Weight	17kg	
Dimensions (L x W x H)		57.2 x 43.3x 4.4 cm (17"/1U)	

## Packing List

Part Number	Description	Amount
41020-009501-00-RS	Rack Mount bracket(Long)	2
41020-009001-01-RS	Rack Mount bracket(Short)	2
LKM-CB18A-RS	1.8M Cable Set	1
32000-000002-RS	18.3 cm round cable power cord	1
19600-000082-RS	Screw Set	1
63SPU45E201-000-RS	AD/DC Power Supply (For AC input Model)	1
63000-ACEN023T-RS	48 VDC/DC Power Supply (For 48VDC input Model)	1
63000-ACEN023C-RS	24 VDC/DC Power Supply (For 24VDC input Model)	1



Convenient OSD Control Buttons



Two internal Speakers with audio on/off switch



Touch pad and two control buttons



Two self-clinch prevents the keyboard from sliding in shaking



Auto-scanning, selecting and editing computer ports by LCD module control buttons

## Features

1. Integrated KVMA console (88 key keyboard and touchpad) with 17" LCD monitor in a 1U rack maximizes space in your control center.
2. Supports up to 1280x1024 resolution
3. Wide viewing angles: 160° wide viewing angle for easy viewing
4. Hot-pluggable capabilities enables the addition or removal of computers without having to power down the switch
5. Multiple languages supported: English, Japanese, German, French, Italian, Traditional Chinese, Spanish, and Russian version keyboard supported.
6. Auto-scan mode: Automatically scan the port with an interval of 10 seconds so that users can monitor their activity automatically. (For LKM-9278G)
7. Editable station name: Allow users to name each computer station on the LCD module to easily manage every station. (For LKM-9278G)
8. Optional DC power input: 48 VDC or 24 VDC power input options for more mobile and server room applications

## Dimensions

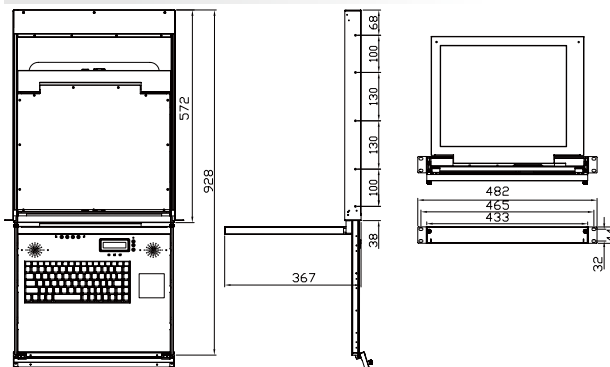

## Ordering Information

<b>LKM-927G [ C ] - [ L ]</b>	Single input 17" LCD Monitor/Keyboard/Mouse/Speaker 1U Drawer with individual Monitor and Keyboard module, AC input.
<b>LKM-927G [ C ] T - [ L ]</b>	Single input 17" LCD Monitor/Keyboard/Mouse/Speaker 1U Drawer with individual Monitor and Keyboard module, 48VDC input.
<b>LKM-927G [ C ] C - [ L ]</b>	Single input 17" LCD Monitor/Keyboard/Mouse/Speaker 1U Drawer with individual Monitor and Keyboard module, 24VDC input.
<b>LKM-9278G [ C ] - [ L ]</b>	8 inputs 17" LCD Monitor/Keyboard/Mouse/Speaker 1U Drawer with individual Monitor and Keyboard module, AC input.
<b>LKM-9278G [ C ] T - [ L ]</b>	8 inputs 17" LCD Monitor/Keyboard/Mouse/Speaker 1U Drawer with individual Monitor and Keyboard module, 48VDC input.
<b>LKM-9278G [ C ] C - [ L ]</b>	8 inputs 17" LCD Monitor/Keyboard/Mouse/Speaker 1U Drawer with individual Monitor and Keyboard module, 24VDC input.

Note:  
[C]:Color Code B: Black W: White  
T:48VDC Power Input Model  
C:24VDC Power Input Model  
[L]:Language Code EN:English, JP:Japanese,DE:German, FR:French, IT:Italian, TW: Traditional Chinese, SP:Spanish, RU: Russian

1  
Automation

2  
Point of Service

3  
Digital Signage

4  
RISC-based Solutions

5  
Medical Solutions